

Submersible Turbines	
Section	ST-5TMH
Page	1.0
Date	February 4, 2021
Supersedes	June 4, 2018

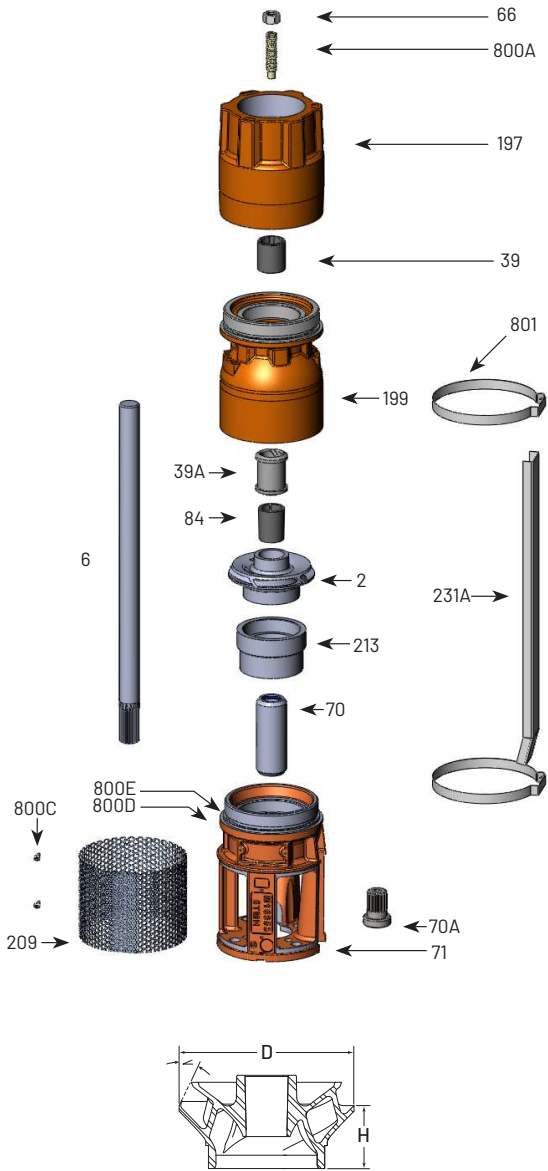

TABLE 1 - 5TMH-110 Common Parts Group

Item Number	Part Number	Description	Material	Material Reference	Required Qty (per stage)
2	See Table 3	Impeller	316 stainless steel	AISI 316 UNS S31600	1
6	See Table 4	Shaft	416 stainless steel	AISI 416 UNS S41600	1
39	M15886	Top Bearing	Vesconite		1
39A	S13636	Bowl Bearing	Rubber	Neoprene	1
66	M15881	Uphrust Nut, 1/2-13 LH			1
70	B86966	6" Motor Coupling	416 stainless steel	AISI 416 UNS S41600	1
70A	M15847	4" Motor Coupling	416 stainless steel	AISI 416 UNS S41600	1
71	M16053	Motor Suction Bracket(1)	ductile iron	ASTM A536-84 64-45-12	1
84	S05301	Collet, 1"	steel	AISI 1226	1
199	B86447	Bowl, with bearing	class 30 grey iron	ASTM A48 Class 30	1
197	M16055	Discharge adapter(2)	ductile iron	ASTM A536-84 64-45-12	1
209	M16056	Suction Screen	302 stainless steel	AISI 302 UNS S30400	1
231A	308666000	Cable guard	302 stainless steel	AISI 302 UNS S30200	see Table 4
800A	M15882	Uphrust Screw, 1/2-13 LH			1
800C	M15937	Suction Screen Screw, 8-32 x 3/8 PH			2
801	M15878	Cable guard clamp			2
Not illustrated	B86187	Bolt Kit, 6" motor			1
Not illustrated	M15847	Adapter Kit, 4" motor			1
Not illustrated	M15847	Adapter Kit, 4" motor			1
B87175 - Literature Package:					
Not illustrated	BE972	Owner's manual			1
Not illustrated	M09970	Tag, Uphrust Adjustment			1
800D	M10199	Rivet, 3/32			2
800E	M12165PNR	Nameplate			1
Not illustrated	M13517	Label, Arrow, Rotation Direction			1
Not illustrated	U27-490	Decal, Berkeley Oval Blue/White			1
Not illustrated	S14447	Label, Pressure Warning			1
Not illustrated	U27-2440	Label, Prop 65 Compliance			2

(1) = motor bracket is dual-machined for 4" and 6" motors

(2) = discharge adapter assembly (p/n B86418) includes items 39, 66, 197, and 800A

TABLE 2 - Additional Staging

Item Number	Part Number	Description	Material	Material Reference	Required Qty (per stage)
39A	S13636	Bowl Bearing	Rubber	Neoprene	1
	S10708	Bowl Bearing (optional)(4)	Bronze		1
199	B86447	Bowl, with bearing	class 30 grey iron	ASTM A48 Class 30	1
84	S05301	Collet, 1"	steel	AISI 1226	1
2	See Table 3	Impeller	316 stainless steel	AISI 316 UNS S31600	1

(4) = bronze bearing may be used in place of the standard Neoprene bearing

TABLE 3 - Impeller Information

Item Number	Part Number	Description / Diameter (D)	Height (H)	Angle ()	"Required Qty (per stage)"
2	M16045	"A" impeller, 4.37" (111mm)	1.925" (48.9mm)	40°	See Table 4
	M16046	"B" impeller, 4.11" (104.4mm)	1.71" (43.4mm)	40°	

Table 4 - 60Hz Staging Requirements Build Table

Series(5)	HP / Kw	Stages	Qty of Each Trim		416 ss shaft(6)		Ion-nitride shaft(6)		Shaft Length in / (mm)	Cable Guard Length(7) in / (mm)	Assembled pump length (motor not included) in / (mm)
			A trim	B trim	Shaft p/n	Pump Catalog Number	Shaft p/n	Pump Catalog Number			
5TMH5-375	5 / 3.7	1	1	-	M16003	B86522	M16015	B86522N	12.75 / (323.9)	9.25 / (235)	18.08 / (459.2)
5TMH7.5-375	7.5 / 5.6	2	-	2	M16191	B86523	M16199	B86523N	19.5 / (495.3)	16 / (406.4)	24.83 / (630.7)
5TMH10-375	10 / 7.5	2	2	-	M16191	B86524	M16199	B86524N	19.5 / (495.3)	16 / (406.4)	24.83 / (630.7)
5TMH15-375	15 / 11.2	4	1	3	M16193	B87199	M16201	B87199N	33 / (838.2)	29.5 / (749.3)	38.33 / (973.6)
5TMH20-375	20 / 14.9	5	3	2	M16194	B87201	M16202	B87201N	39.75 / (1009.7)	36.25 / (920.8)	45.08 / (1145)
5TMH25-375	25 / 18.6	6	4	2	M16195	B87203	M16203	B87203N	46.5 / (1181.1)	43 / (1092.2)	51.83 / (1316.5)
5TMH30-375	30 / 22.4	7	6	1	M16317	B87205	M16543	B87205N	53.25 / (1352.6)	49.75 / (1263.7)	58.58 / (1487.9)
5TMH40-375	40 / 29.8	9	9	-	M16318	B87207	M16544	B87207N	66.75 / (1695.5)	63.25 / (1606.6)	72.08 / (1830.8)
5TMH50-375	50 / 37.3	11	11	-	M16102	B87209	M16135	B87209N	80.25 / (2038.4)	76.75 / (1949.5)	85.58 / (2173.7)
5TMH60-375	60 / 44.7	13	13	-	M16445	B87211	M16646	B87211N	93.75 / (2381.3)	90.25 / (2292.4)	99.08 / (2516.6)

(5) = effective assembled pump diameter, with cable guard lying flat against pump, is 5.625" (143 mm)

(6) = for both 4" and 6" motors, the same shaft and cable guards are used

(7) = Cable Guard p/n 308666000 is sold in 12" (3.66m) lengths only

Stages		
1	Each Additional	18.08 / (459.2)
		6.75 / (171.5)